



Piranha Quick

Cyclonic Bagless Vacuum Cleaner



MODEL NO: 900018

IMPORTANT

- Read this instruction booklet carefully before operation.
- Before using the appliance, check that the mains power voltage corresponds with the voltage shown on the rating plate.
- Always remove the plug from the power socket when the appliance is not in use and before carrying out any maintenance operations.
- Always remove the plug from the power socket before opening the appliance.
- Do not use the appliance to vacuum liquids, due to electric shock hazard.
- Do not use the appliance to vacuum sharp objects.

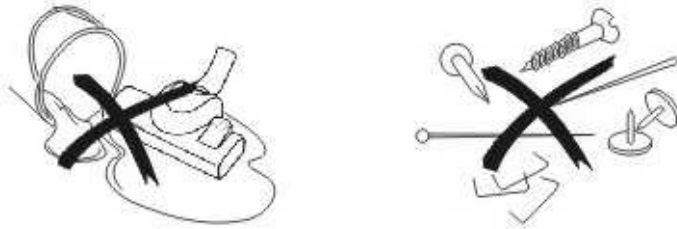

- Do not use the appliance to vacuum lighted cigarettes, hot ashes and any other combustible objects.



- Do not use the appliance to vacuum tiny particles like cement or plaster dust as this will shorten the life of the motor.
- Keep the vacuum cleaner away from stoves, heaters and any other heat emitting appliances. Heat can deform and discolour the plastic parts.

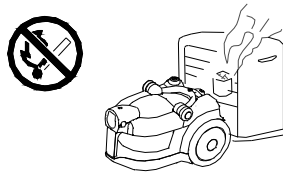

- Do not block the air flow. Blocking the suction in any way (e.g. blocked filters, blocked hose or full dust bag) will decrease the efficiency and will shorten the life of the motor.
- Do not run the vacuum cleaner over the power cable.
- Never leave the appliance unattended when it is switched on.
- The appliance is not intended for use by young children or infirm persons without supervision.
- Young children should be supervised to ensure that they do not play with the appliance.
- This appliance is for domestic use only. Commercial use voids warranty.
- Do not unplug by pulling the power cord. Always unplug by pulling the plug.
- Use as described in this instruction booklet.
- Do not switch the appliance on if it appears to be faulty in any way.
- For repairs or accessories contact the distributor on the contact details outlined in the guarantee.

DESCRIPTION

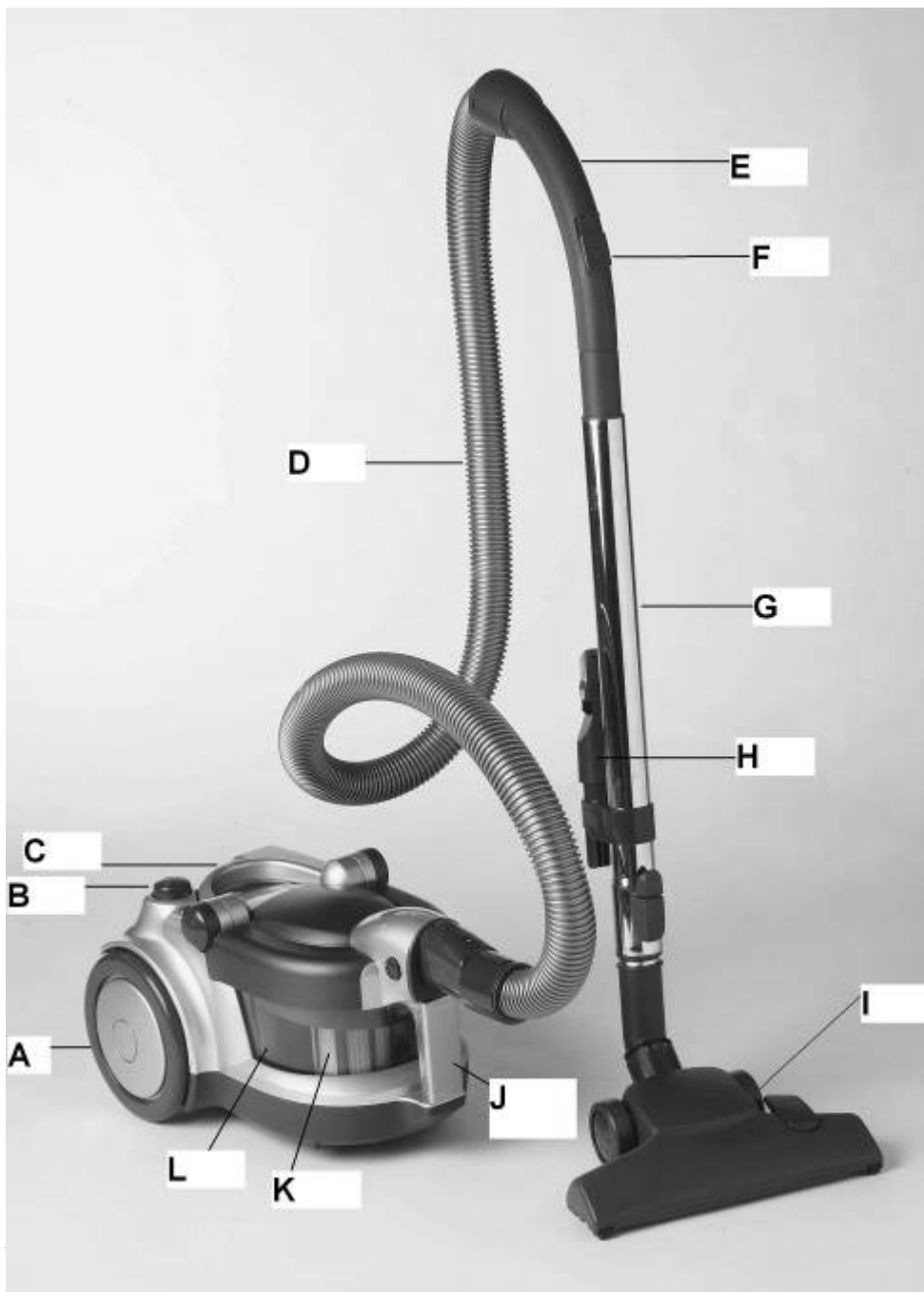

- A** - Large wheels with rubber coating for easy manoeuvrings.
- B** - ON/OFF Button.
- C** - Carry handle and retract cord button (to retract the cord, press the Carry handle down).
- D** - Crush Proof Flexible Hose.
- E** - Curved handle that connects the hose to the telescoping tube.
- F** - Air release cover for suction adjustment (Low or High).
- G** - Steel Chrome Plated Telescoping Adjustable Extension Tube.
- H** - Tool Holder and tool accessory.
- I** - Dual purpose Floor Head switch from carpet to hard floors.
- J** - Dust Container Handle.
- K** - HEPA Filter.
- L** - Transparent Dust Container.

HEPA Filter and Cover:



HEPA COVER

HEPA FILTER

HEPA Filter Cover – it is actually a filter mesh that filters the larger particles of dirt.

HEPA Filter – HEPA stands for **H**igh **E**fficiency **P**articulate **A**ir, which means a very effective filter that can stop the smallest particle of dust, pollen, bacteria etc. from becoming an airborne allergen.

HEPA Filter Housing and Dust Container:

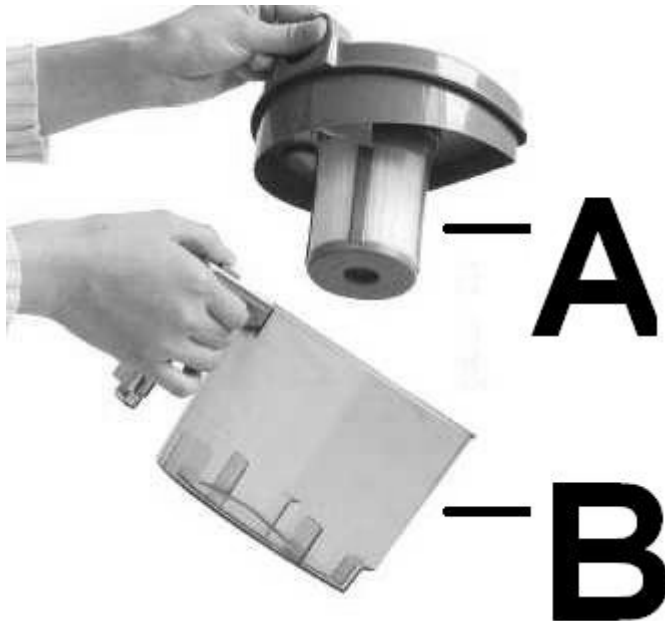

A – HEPA Filter and Dust Container Cover.

B – Transparent Dust Container.

ASSEMBLING THE VACUUM CLEANER

Please Note: Always remove the plug from the power socket before fitting or removing accessories

Fitting the Flexible Hose

Insert the flexible hose into the hose socket on the front cover of the appliance. Press the flexible hose into the hose socket until the hose clicks into place.



Removing the Flexible Hose

To remove the flexible hose, press the locking buttons on the top of the hose base to release the lock and pull the flexible hose out of the hose socket.



Fitting the Extendable Telescoping Tube and Accessories

Attach the Telescoping tube to the curved handle of the flexible hose.



Attach the preferred cleaning accessory to the end of the Telescoping tube.



Removing the Extendable Telescoping Tube and Accessories

To remove the telescoping tubes and accessories, hold each piece tightly and pull firmly apart.

OPERATION METHOD

1. Before using the vacuum cleaner unwind the length of power cord required and insert the plug into the power socket. A YELLOW mark on the power cord indicates the ideal cable length. Do not extend the power cord beyond the RED mark.
2. Press the On/Off Switch Pedal to switch the vacuum cleaner ON. If you press the ON/Off switch again the vacuum cleaner will be turned off.
3. You can adjust the Suction by sliding the Air Intake Slide Button Control on the curved handle to control the suction. The suction will be reduced the more you open the slide. For maximum suction keep the slide close.



4. **Choose a suitable suction according to the surface to be cleaned:**
For Carpets - you will need Maximum suction.
For Hard Floors - you will need Maximum to Medium suction.
For Curtains or Sofas – you will need Medium to Minimum suction.
5. **Using the Adjustable Floor Brush:**
For Carpets – The bristles should be in (retracted) to enable the floor head to glide on the carpet while cleaning.
For Hard Floors – The bristles should be out (extended). You will need to press the switch on the floor brush down to get the bristles out. The bristles will collect the dirt and protect the hard floors surface from scratches.

Using the Cleaning Accessories

- **Dual Position Carpet / Floor Brush**

Position 1: Bristles extended
- For hard floors

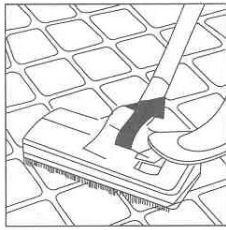

Position 2: Bristles retracted
- For carpets

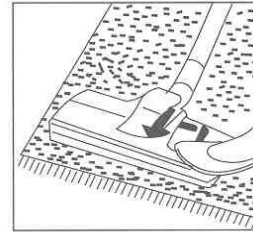

- **Brush and Nozzle tool**

Piranha Quick comes with one accessory tool which is a crevice tool and a brush tool.



For cleaning corners, edges, drawers, curtains, shelves, books, inlaid furniture, lamps and other delicate or hard to reach objects.

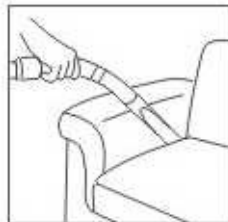

Turning the Vacuum Off

After you have finished cleaning, turn the vacuum off by pressing the On/Off switch. Only then unplug the power plug from the power socket. Press the rewind button with one hand, and guide the cord with the other hand to ensure that it does not cause damage during winding

MAINTENANCE

To Empty Dust/Rubbish Container

1. Remove the flexible hose from the hose socket.
2. Open the front cover by pressing the buttons from both sides and lifting the cover.



3. Once you have opened the top cover of the vacuum cleaner, hold the dust container handle, press the orange release button and pull the dust container out.



4. Remove the dust container cover and HEPA filter, and tip the rubbish into a rubbish bin.



Maintaining Filters

Please Note: It is very important to keep the filters clean to receive maximum performance from the vacuum. Not cleaning and not replacing your filters regularly can reduce the suction power and cause overheating.

Cleaning the the HEPA Filter and HEPA Filter Cover

1. First you need to get the filter out of its housing, by twisting it and pulling it out (see photo below).



HEPA COVER



HEPA FILTER

2. Take off the HEPA Filter cover, wash under running water and allow the filter to dry completely before replacing it in the vacuum.

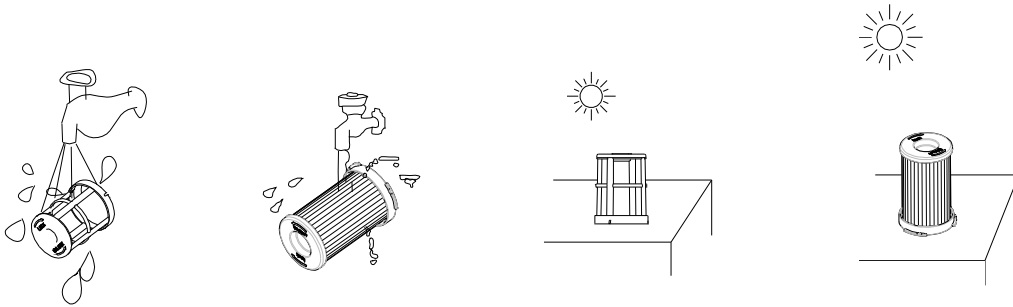

Cleaning the the Exhaust Filter

3. To clean the exhaust filter, detach the grill by pulling firmly away from the Vacuum Cleaner.

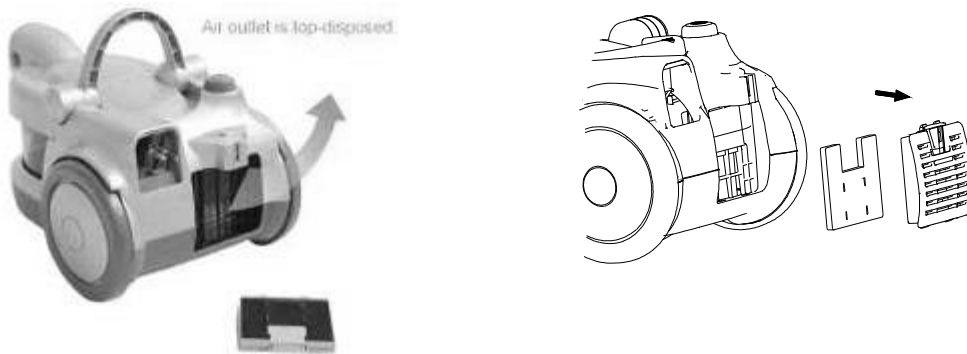

4. Remove the foam filter and wash it under running water and allow it to dry completely before placing it back in the appliance.
5. Filters should be maintained regularly to get maximum performance from the vacuum cleaner.
6. If filters are broken or worn, replace them before continuing to use the vacuum.
7. Filters can be purchased from the distributor or call H. E. GROUP Customer Service on toll free 1800 079 124.

Cleaning the Vacuum

1. Do not clean the vacuum using petrol or any other flammable liquid.
2. Clean only the outside of the vacuum cleaner.
3. Use only a moist cloth and detergent for cleaning the vacuum cleaner.
4. After cleaning, wipe off the moisture on vacuum cleaner with dry cloth.

Cyclonic Airflow:

To keep the suction of the Piranha Quick at maximum efficiency, the air that enters the Piranha Quick is flowing in a cyclonic centrifugal airflow. In this way the rubbish is pushed to the edges of the dust container and allows maximum airflow and suction.

