



PIRANHA MAGNUM 1800W Vacuum Cleaner USER MANUAL



MODEL NO: 900016

DESCRIPTION



IMPORTANT

- Read this instruction booklet carefully before operation.
- Before using the appliance, check that the mains power voltage corresponds with the voltage shown on the rating plate.
- Always remove the plug from the power socket when the appliance is not in use and before carrying out any maintenance operations.
- Always remove the plug from the power socket before opening the appliance.
- Do not use the appliance to vacuum liquids due to electric shock hazard.
- Never leave the appliance unattended when it is switched on.
- The appliance is not intended for use by young children or infirm persons without supervision.
- Young children should be supervised to ensure that they do not play with the appliance.
- This appliance is for domestic use only. Commercial use voids warranty. Use as described in this instruction booklet.

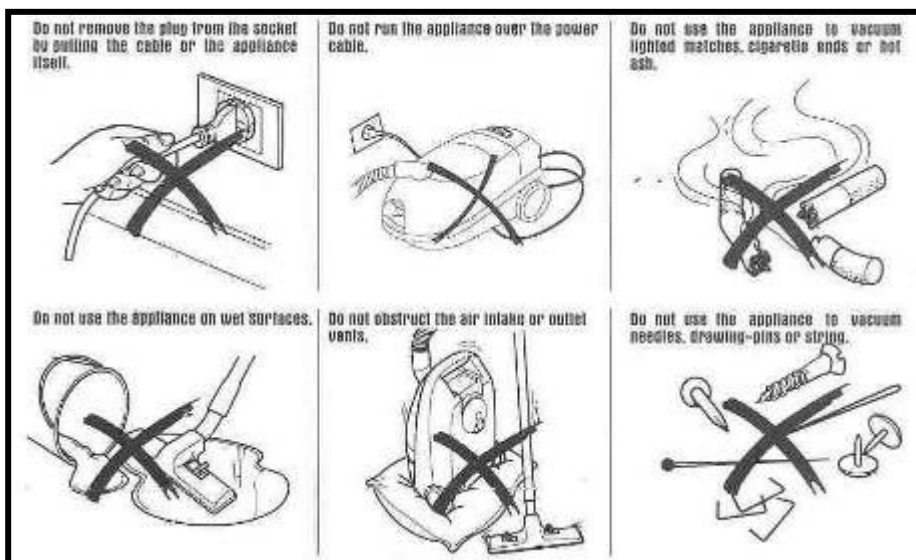

- Do not switch the appliance on if it appears to be faulty in any way. For repairs or accessories contact the distributor on the contact details outlined in the guarantee.

PIRANHA MAGNUM MAXIMUM PARTICLE FILTRATION SYSTEM

HEPA (High Efficiency Particulate Air) filters are an effective system in removing almost all indoor pollutants, dust mites, pollen and mould spores.

ASSEMBLING THE VACUUM CLEANER

Always remove the plug from the power socket before fitting or removing accessories

Fitting the Flexible Hose

Insert the flexible hose into the hose socket on the front cover of the appliance. Press the flexible hose into the hose socket until the hose clicks into place.



Removing the Flexible Hose

To remove the flexible hose, press the locking buttons on the base of either side of the flexible hose to release the lock. Pull the flexible hose out of the hose socket.

Fitting the Telescopic Tubes and Accessories

Attach the telescopic tubes to the curved handle of the flexible hose. To extend the tubes, push on the button at the centre join and pull the inner tube outward.



Attach the preferred cleaning accessory to the end of the telescopic tube.

Removing the Telescopic Tubes and Accessories

To remove the plastic tubes and accessories, hold each piece tightly and pull firmly apart.

OPERATION METHOD

1. Unwind the length of power cord required and insert the plug into the power socket. A YELLOW mark on the power cord indicates the ideal cable length. Do not extend the power cord beyond the RED mark.



2. Press the On/Off Switch Pedal to switch the appliance ON.



3. Adjust the Suction control knob on the curved handle to control the suction. The suction will be reduced with a larger air opening.

4. Adjust the Power Control Dial to the Min or max Power setting you require. This function controls the power of the motor. It is recommended to keep it on Max to receive full benefit from the vacuum.

Retracting Cord

To rewind cord press the cord rewinding pedal. CAUTION: Cord retracts very quickly. Take care to avoid injury.

Using the Cleaning Accessories

- **Dual position carpet / floor brush**

Position 1: Bristles extended
- For hard floors

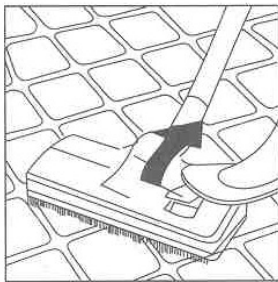

Position 2: Bristles retracted
- For carpets

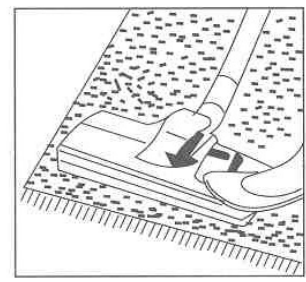

- **Integrated Brush and Nozzle**

For cleaning radiators, corners edges, drawers, curtains shelves, books, inlaid furniture, lamps and other delicate objects.



MAINTENANCE

NOTE: Always remove the power plug from the wall outlet before carrying out any maintenance.

Cleaning the Dust Canister

1. Remove the flexible hose from the hose socket.
2. Press the Dust Canister release button and lift out from the housing.
3. To open, twist and slide the dust container out of the housing using the handle. Empty contents into a rubbish bin.



Twist and slide to open dust container



4. To close the container it is important that the 2 arrows (as shown below) are matched and the dust container has been clipped securely into the lid.



This groove must be clipped into the lid

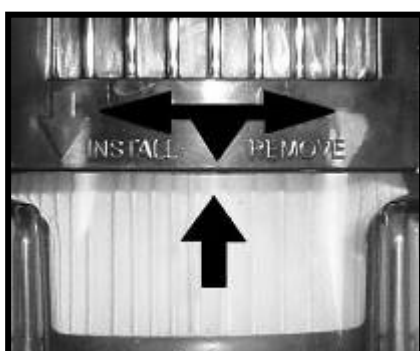

5. Once the base container has been clipped into place, twist towards the centre arrow to lock in place.
6. Fit the dust container back into the vacuum cleaner.

Maintaining Filters

It is very important to keep the filters clean to receive maximum performance from the vacuum. Not cleaning and not replacing your filters regularly can reduce the suction power and cause overheating.



Pre- Motor Filter

1. To clean pre-motor filter, Lift the dust canister out and remove the filter from its housing
2. Wash under running water and allow the filter to dry completely before replacing it in the vacuum.

3. To clean the HEPA filter, remove the filter from the dust container. To remove the HEPA filter from its housing, twist clockwise. Shake or brush away dust from filter and replace.

4. To clean the exhaust filter, detach the grill by pulling firmly away from the appliance.

5. Remove the filter and wash under running water and allow to dry completely before replacing it in the appliance.

6. Hepa Filters should be replaced approximately every few months depending on how frequently the appliance is used.



HEPA Filter



Exhaust Filter

