

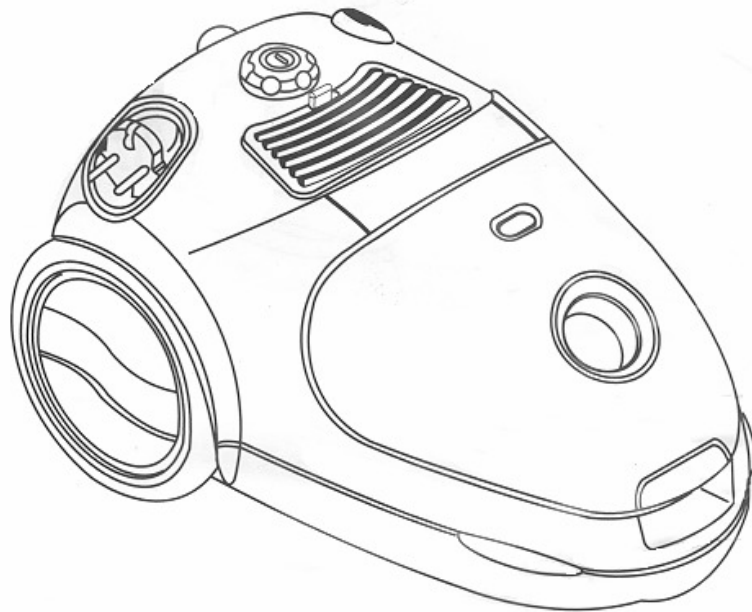

# **Piranha Funky Vacuum Cleaner**

## **USER MANUAL**



**MODEL NO: 900023**

## DESCRIPTION

- A. Curved Handle
- B. Flexible Hose
- C. Suction Control
- D. 2 Metal Extension Tubes
- E. Adjustable Floor Brush
- F. Hose Socket
- G. Front Cover
- H. Dust Bag Indicator
- I. Power Cord
- J. On / Off Switch
- K. Cord Rewinding Pedal

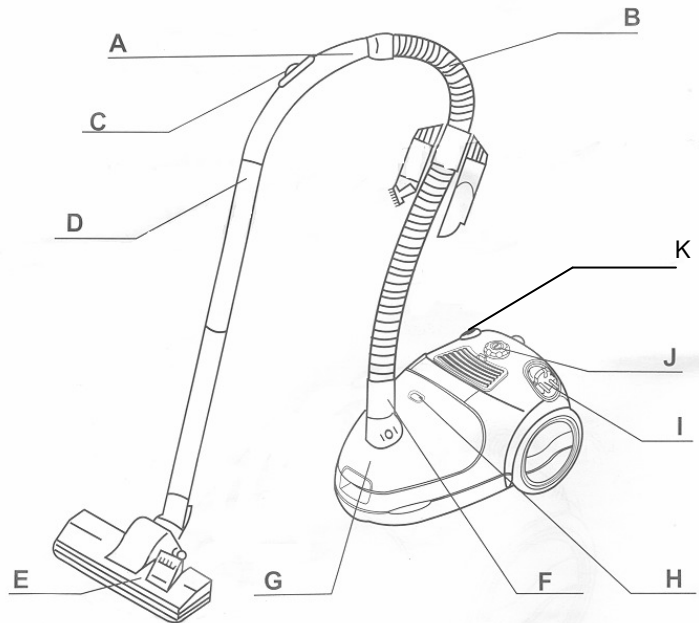

## IMPORTANT

- Read this instruction booklet carefully before operation.
- Before using the appliance, check that the mains power voltage corresponds with the voltage shown on the rating plate.
- The appliance should be connected to a correctly earthed power socket.
- Always remove the plug from the power socket when the appliance is not in use and before carrying out any maintenance operations.
- Always remove the plug from the power socket before opening the appliance.
- Do not use the appliance to vacuum liquids due to electric shock hazard.
- Never leave the appliance unattended when it is switched on.
- The appliance is not intended for use by young children or infirm persons without supervision.
- Young children should be supervised to ensure that they do not play with the appliance.
- This appliance is for domestic use only. Commercial use voids warranty. Use as described in this instruction booklet.
- Do not switch the appliance on if it appears to be faulty in any way.
- For repairs or accessories contact the distributor on the contact details outlined in the guarantee.

Do not remove the plug from the socket by pulling the cable or the appliance itself.

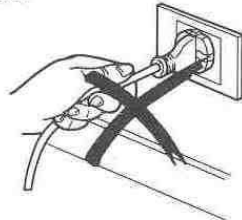

Do not run the appliance over the power cable.

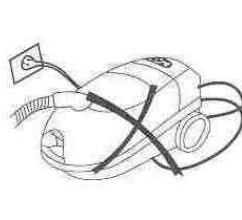

Do not use the appliance to vacuum lighted matches, cigarette ends or hot ash.



Do not use the appliance on wet surfaces.

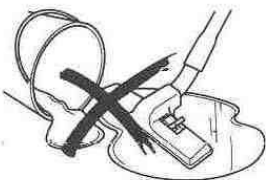

Do not obstruct the air intake or outlet vents.



Do not use the appliance to vacuum needles, drawing-pins or string.



## **PIRANHA DART FIVE FILTRATION LEVEL**

Excellent five filtration levels for maximum dust retention.

1<sup>st</sup> filter - Cloth dust bag

2<sup>nd</sup> & 3<sup>rd</sup> filters - two layer pre-motor filters located in the dust bag cabinet.

4<sup>th</sup> & 5<sup>th</sup> filters - two layer exhaust filters located under the exhaust grill.

## **ASSEMBLING THE VACUUM CLEANER**

*Always remove the plug from the power socket before fitting or removing accessories*

### **Fitting the Flexible Hose**

Insert the flexible hose into the hose socket on the front cover of the appliance. Press the flexible hose into the hose socket until the hose clicks into place.

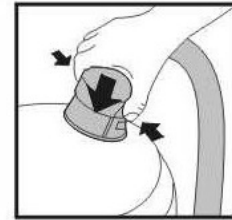

### **Removing the Flexible Hose**

To remove the flexible hose, press the locking buttons on the base of either side of the flexible hose to release the lock. Pull the flexible hose out of the hose socket.

### **Fitting the Metal Extension Tubes and Accessories**

Attach the first metal tube to the curved handle of the flexible hose.

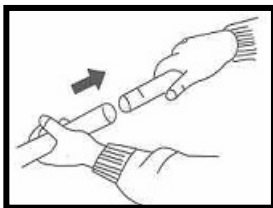
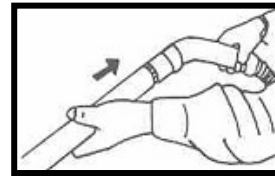

Attach the second metal tube to the first tube and clip on accessory clip.

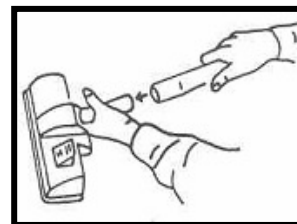

Attach the preferred cleaning accessory to the end of the second metal tube.

### **Removing the Metal Extension Tubes and Accessories**

To remove the Metal tubes and accessories, hold each piece tightly and pull firmly apart.

## **OPERATION METHOD**

1. Unwind the length of power cord required and insert the plug into the power socket. A YELLOW mark on the power cord indicates the ideal cable length. Do not extend the power cord beyond the RED mark.
2. Press the On/Off Switch Pedal to switch the appliance ON.
3. Adjust the Suction control knob on the curved handle to control the suction. The suction will be reduced with a larger air opening.

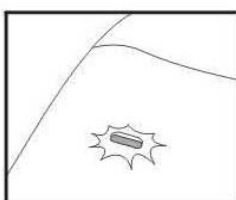

### **Dust Bag Indicator**

When the suction tube is obstructed or the dust bag is full, the Dust Bag Indicator will appear RED. In this case, replace or clean the dust bag or remove the obstruction.

### **Retracting Cord**

To rewind cord press on cord rewinding pedal.

**CAUTION:** Cord retracts very quickly. Take care to avoid injury.

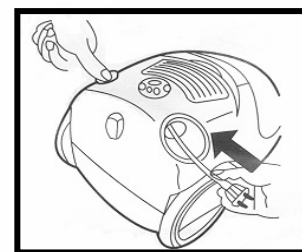

### **Using the Cleaning Accessories**

- **Dual position carpet / floor brush**

Position 1: Bristles extended  
- For hard floors

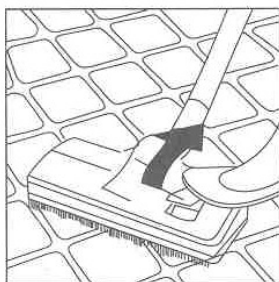

Position 2: Bristles retracted  
- For carpets

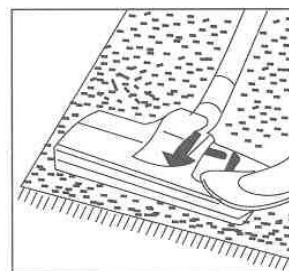

- **Brush and Nozzle**

For cleaning radiators, corners edges, drawers, curtains shelves, books, inlaid furniture, lamps and other delicate objects.

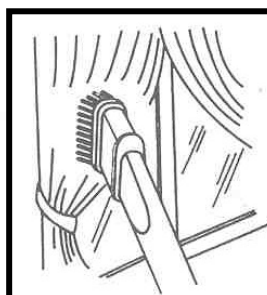
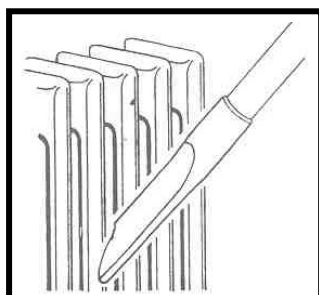

## **MAINTENANCE**

### **Replacing the Dust Bag**

1. Remove the flexible hose from the hose socket.

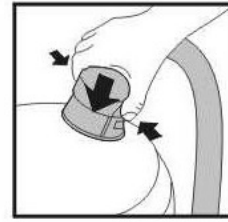

2. Open the front cover by releasing the clasp and lifting the cover.
3. Slide the dust bag out of the housing .
  - When using a reusable cloth bag, slide the bag seal on the bottom of the dust bag off and empty the waste. Replace the bag seal.
  - When using a paper bag, dispose of entire bag.

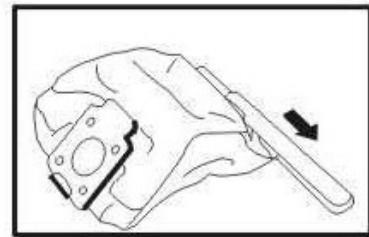
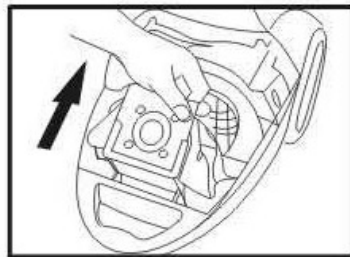

4. Slide the clean dust bag between the clips of the housing in the direction indicated by the arrows on the dust bag housing.
5. Close the front cover ready for operation.

### **Maintaining Filters**

***It is very important to keep the filters clean to receive maximum performance from the vacuum. Not cleaning not replacing your filters regularly can reduce the suction power and cause overheating.***

1. To clean pre-motor filter, remove the filter from its housing located in the dust bag cabinet.
2. Wash under running water and allow the filter to dry completely before replacing it in the vacuum.
3. To clean the exhaust filter, detach the grille by pulling firmly away from the appliance.
4. Remove the filter and wash under running water and allow to dry completely before replacing it in the appliance.
5. Filters should be replaced approximately every few months depending on how frequently the appliance is used.
6. Filters can be purchased from Funtastic Ltd via Customer Care by calling the free number: 1800 660 655.

