



Party Drinks Maker

User Manual



Model No.: HJ-004

Item No.: 900559

240V a.c. 16W

Rev 2

READ AND SAVE THESE INSTRUCTIONS

Note: The specifications and/or components of this appliance are subject to change without prior notice

1	Safety Instructions	3
2	Components	5
3	Features	6
4	Instructions For Use	6
4.1	Before first use	6
4.2	Assembling the Drink Maker	6
4.3	Using Your Drink Maker	7
5	Care and Cleaning	10
6	Helpful Hints	11
7	Recipes	12
7.1	Smoothies	12
7.2	Juicy Party Drink	12
8	Schematic Wiring Diagram	13
9	Guarantee	14

1 Safety Instructions

When using electrical appliances, basic safety precautions should always be followed, including the following:

- Carefully read this instruction manual before using appliance.
- Keep appliance out of reach of young children.
- This appliance is not intended for use by persons (including children) with reduced physical, sensory or mental capabilities, or lack of experience and knowledge, unless they have been given supervision or instruction concerning use of the appliance by a person responsible for their safety.
- Children should be supervised to ensure that they do not play with the appliance.
- Ensure children and babies do not play with plastic bags or any packaging materials.
- **VERY IMPORTANT:**
Ensure that appliance does not get soaking wet.
Do not use appliance with wet hands.
Do not immerse appliance in water or other liquids or use near sinks, baths or showers.
- Always operate the appliance from a power source of the same voltage, frequency and rating as indicated on the product identification plate.
- Position the power supply lead properly so that they will not be walked on or pinched by items placed on or against them.
- Use appliance only for its intended use. Appliance is intended for household use only and not for commercial or industrial use.
- Do not use appliance if it has been dropped or any part of appliance (including cord or plug) has been damaged. Take appliance to your nearest authorised service centre or qualified dealer for inspection or repair.
- Use only accessories recommended or supplied by an authorised service centre or qualified dealer. The use of accessories not intended for use with this appliance may cause injuries to the user or damage to the appliance.
- Do not install the unit on other appliances, on uneven surfaces or where it could be subject to: heat sources (e.g. radiators or stoves), direct sunlight, excessive dust or mechanical vibrations.
- Appliance should not be used outdoors, placed near a hot gas or electrical burner or placed in a heated oven.
- Do not install near any heat sources such as radiators, heat registers, stoves, or other apparatus that produce heat.
- Do not operate appliance underneath or near flammable or combustible materials (e.g. curtains).
- Unplug this apparatus during lightning storms or when unused for long periods of time.

- Turn off and unplug before cleaning or storing.
- Any type of servicing, apart from ordinary cleaning, must be carried out by an authorised service centre or qualified dealer. There are no user serviceable parts in this appliance.
- If this appliance is used by a third party, please supply the instruction manual with it.
- Do not misuse the cord. Never carry the appliance by the cord or pull to disconnect it from the outlet. Instead, grasp the plug and pull to disconnect.
- To fix stably, the appliance must be placed on a flat and solid surface. It should not be laid on any soft material.
- Turn off and unplug the unit before moving.
- Do not place any other appliance or objects on top of the appliance.
- Do not plug into the power socket before set up is completed.
- Please ensure that the appliance is plugged directly into the electrical outlet.
- Avoid contact with moving parts. Keep hands, hair and clothing, as well as spatulas and other utensils, away during operation to prevent injury and/or damage to the appliance.
- Do not place any part of this appliance in a dishwasher.
- Do not add more than the recommended amount of salt.
- Do not place ice container in freezer.
- Do Not put fingers etc inside the mixing or ice containers whilst switched on or in use.
- No liability can be accepted for any damage caused by non-compliance with these instructions or any other improper use or mishandling of appliance.

Read and Save These Instructions

2 Components

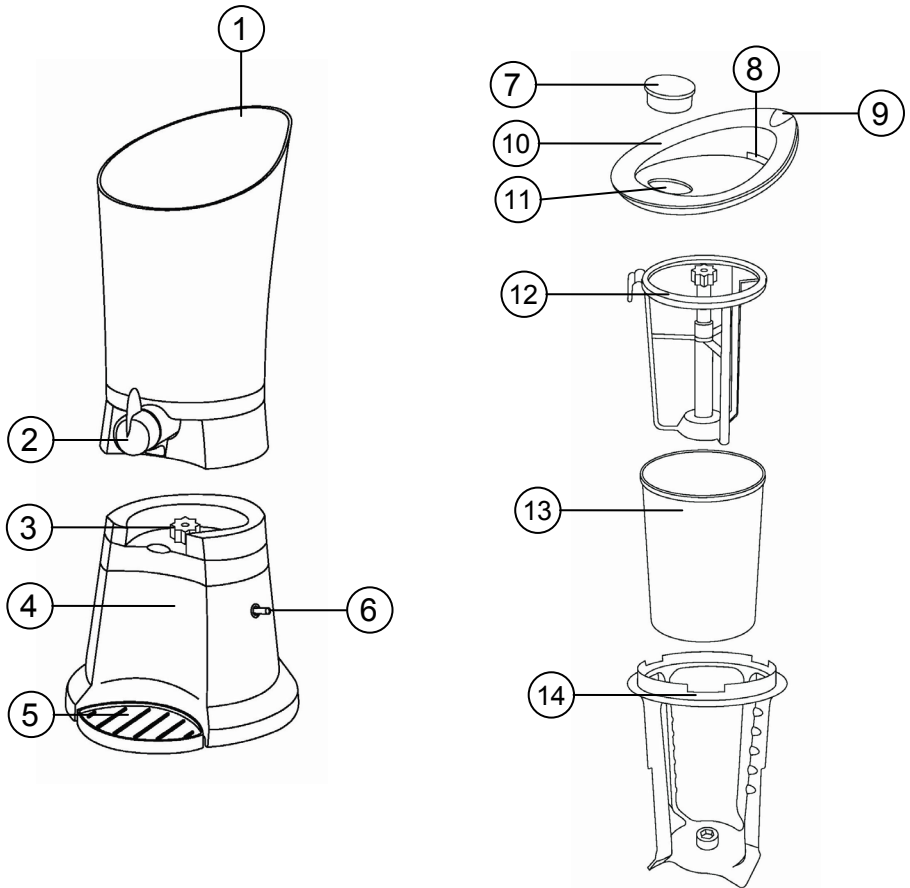

1	Drink Container	8	Drink Mixture Slot
2	Tap	9	Lid Fastening Clip
3	Drive Coupling	10	Lid
4	Motor Housing / Base	11	Ice / Salt Opening
5	Cup Stand	12	Ice / Salt Mixer Paddles
6	On / Off / Reverse Switch	13	Ice / Salt Container
7	Ice / Salt Cap	14	Drink Mixer / Scraper Paddles

3 Features

Large Drink Container

34 oz (1 litre) capacity Drink container.

Efficient Dispensing

Dual action agitator- Drink paddles change direction in the dispense position to scrape the ice crystals through the dispensing tap more efficiently.

4 Instructions For Use

4.1 Before first use

Remove all packing materials from inside your Drink maker.

Thoroughly Hand wash all the parts, (the ice container, ice paddles, Drink paddles and the Drink container), making sure that the dispensing tap is open when washing to allow water to flow through.

Follow the cleaning instructions in this manual.

Do Not immerse the motor unit in water or liquid.

4.2 Assembling the Drink Maker

Note: Do not plug the power cord into an electrical outlet until the unit is fully assembled.

- Place the Drink Container on the motor base ensuring that the container is sitting correctly on the drive coupling.
- Make sure the Tap is facing forward as shown.

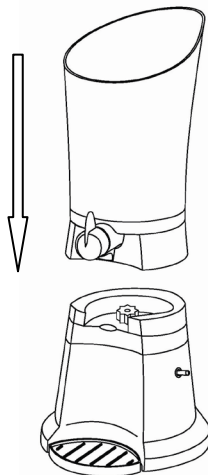

- Insert the ice container into the Drink paddles, then insert the ice paddles into the ice container.



- Place the ice container assembly into the Drink container, ensuring that the ice container sits properly onto the drive coupling at the base of the Drink container.

4.3 Using Your Drink Maker

- Your Drink maker can make up to 1 litre of Drinks or an individual serving size.
- The ingredients will decrease in volume once the ice crystals have formed, however to ensure that the brine (ice and salt) used to make Drinks, or especially, the Drink mixture is not contaminated with the brine, you must not exceed the capacity of 1 litre of liquid in the Drink container.

Note: During operation, the motor may be quite noisy. THIS IS NORMAL. It may appear to struggle and make a loud grating noise, but continue with the operation.

- After assembling the components as described, place the lid on top of the Drink container and clip shut.
- Plug in and switch on at the power point.

- Once the lid is secured to the ice container, start the unit by flipping the Mix / Off / Dispense switch up to the “Mix” position. The Drink and ice paddles will begin to rotate.

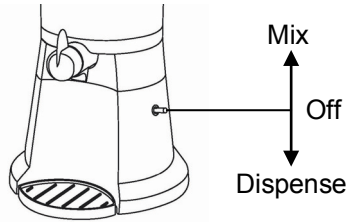

NOTE: Ensure that the Tap is in the closed position to avoid spillage.

- To fill the ice canister, place 60ml of chilled water into the ice canister through the ice / salt opening in the lid.
- Fill the Ice canister half full with ice cubes. **HINT:** Regular square ice cubes work best.
- Using the Ice / Salt Cap as a measuring device, add 1 cap full of rock salt or coarse sea salt to the ice cubes.
- Add more ice to the ice container leaving approximately 1-inch (25mm) below the rim of the ice canister. This leaves room to add more ice and salt if required later.
- Add another cap full of rock salt or coarse sea salt to the ice cubes.
- Fit the Ice / Salt cap to the lid.



NOTE: In some conditions (i.e. High Humidity) adding the ice, water and salt prior to starting the paddles rotating may cause the paddles to freeze and stick to the canister.

Should this happen, briefly set the “Mix / Off / Dispense” switch to the Dispense position and then back to the Mix position to try and un-stick the paddles.

If this fails to un-stick the paddles, it is best to remove the Ice, water and salt from the canister, place the canister under warm running water to unfreeze the paddles and then replace the canister and fit the lid.

This time, set the paddles rotating first by setting the lid the switch to the “Mix” position and then add the ice, water and salt through the opening in the lid.

- Slowly pour the Drink mixture into the rear section of the lid. The liquid will pour into the Drink container.



- You will begin to see the mixture rotating in the Drink container.

CAUTION: Do not exceed 1 litre of liquid indicated with a MAX line on the Drink container

NOTE: Place a cup or glass on the drink tray under the tap when the unit is running in case of dripping.

- Leave the unit running for approximately 10 - 15 minutes, depending on the Drink mix used or until the mixture reaches the desired consistency.
- Do not turn the unit Off during use as the mixture may thaw and the mixing paddles may freeze to the Ice container.
- Add more ice cubes and salt every 10 minutes if necessary through the ice / salt opening.

NOTE; Do Not run for more than 40 minutes at a time. Allow the unit to cool down for approximately 15 minutes after every 40 minutes of use.

CAUTION: Do **NOT** over fill the ice canister. Leave approximately 1 inch (25mm) from the top as there is a risk that the Drink mixture will become contaminated with the salty water.

IMPORTANT: Do not use the Drink maker to freeze liquids without any sugar (such as water) as this may damage the appliance. Water will freeze very quickly to the exterior of the ice canister and could damage the unit.

Dispensing Drinks

- When peaks form, the Drink mixture has reached the best consistency.
- To dispense the Drink mixture, flip the Mix / Off / Dispense switch down to the "Dispense" position. This will reverse the direction of the paddles.
- Place a serving cup onto the Cup Stand, then turn the Tap clockwise, to the "open" position.
- The Drink mixture will begin to pour out into the glass.
- To shut off the dispenser, turn the tap handle anticlockwise.
- Continue to dispense the Drink Mix into more cups.
- Switch to the "Off" position when you are finished dispensing the Drink mix and then unplug the appliance

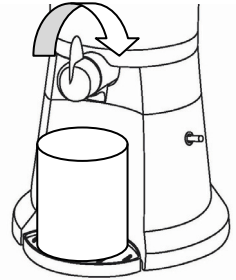

5 Care and Cleaning

- Turn off and unplug the unit prior to cleaning.
- Do not wash any part of the appliance in the dishwasher. Hand wash only.
- Do Not immerse the motor base in water.
- The exterior surface of the motor base can be wiped clean with a damp cloth.
- Remove the Drink container from the motor base and remove the lid.
- Remove the ice container assembly from the Drink container by pulling straight up.
- Discard the brine (ice water & salt) from the ice container.
- Carefully lift locking latches from the ice paddles and disassemble the ice container assembly.
- Do not place any parts of this unit in the dishwasher as damage will occur.
- To clean the Drink container, rinse under warm water, fill with warm soapy water and open the tap to allow clean water to run through. Use a small flexible bottle brush to clean the inside of the tap.
- To Clean the ice container, paddles and lid, hand wash with warm, soapy water and rinse well. Wipe completely dry

DO NOT use flammable liquids, chemicals, abrasive creams, steel wool or scouring pads for cleaning as these may damage your appliance.

6 Helpful Hints

Smoothies can be made into Drinks however, the chilling/freezing time should be increased to achieve the creamy frozen texture desired.

Carbonated drinks can be used to make Drinks such as cola, root beer, creamy soda, etc,

NOTE: Do Not use Carbonated diet drinks as these will not freeze.

It is best to chill most mixtures in the fridge or freezer for some hours before pouring into the Drink container as this will speed up the chilling / freezing process.

If creating alcoholic drinks such as pina colodas or daiquiris, add the alcohol in the last 2 minutes of the process, as alcohol does not freeze and this will alter results when added in with the mixture.

Drink mixtures with higher sugar content will reach desired consistency more quickly than those with skim milk or lower sugar content.

Artificial sweeteners can be substituted instead of sugar. In this case, cool the liquid ingredients for approximately 10 minutes in the freezer. Lower sugar content drinks take longer to freeze. This process will help decrease the running time.

Fresh fruit drinks should be blended first to achieve optimum results. In addition you may need to add more sweetener as natural fruit sugars lessen in taste when frozen.

Always start with liquid mixtures when preparation begins. Do not use milk products or liquids high in fat such as coconut milk, full cream milk, etc. Do not use stiff mixtures such as whipped cream, clotted cream or frozen liquids.

Do not operate the unit longer than required. If after 40 minutes the mixture is not yet achieved the Drink consistency, or has thawed again, do not continue.

Possible reasons for mixture not chilling/freezing:

- a) The ice container was not cold enough, more ice and salt should have been added.
- b) The Drink mixture was too warm
- c) Alcohol was added to the mixture too early.

Do not store Drinks in the freezer or fridge. They should be consumed immediately.

7 Recipes

NOTE: You can reduce the running time for the Drink maker reducing the amount of liquids.

Each recipe below makes approximately 500ml. A maximum of 1 litre can be made if the recipes are doubled.

7.1 Smoothies

Orange Creamsicle

300ml Skim Milk
100ml Orange Juice
100ml Sunny D Orange Beverage
1/8 tsp Vanilla extract

Cappuccino Cooler

390ml Chilled Espresso Coffee
110ml Skim Milk
Sugar (to taste)
This recipe requires more sugar than an average coffee.

Peachy-Keen Smoothie

210ml Blended Peaches
230ml Pineapple Juice
60ml Lemon Juice
Important: Mix Ingredients in a blender, chill, then place in Drink container

Mango Madness

270ml Pureed Mango
140ml White Grape Juice
90ml Skim Milk
Mix ingredients together in a container or bowl before pouring into the Drink container.

7.2 Juicy Party Drink

Old Fashion lemon Ice

375ml chilled lemonade
125ml fresh lemon juice
2 tablespoons sugar
1 teaspoon grated lemon rind

Sunny Frost Tea

320ml Iced Tea
60ml Lemonade
60ml Orange Juice
60ml Grapefruit Juice

O. J. G. Slugger

375ml Grape Juice
125ml Orange Juice

Mellowed Yellow

440ml lemon lime Sports Drink
60ml Pineapple Juice

Tropical Fruit Cup

60ml Lemon Juice Pulp
60ml Pineapple Juice
190ml Grape Juice
190ml Lemon-lime Soda

Frozen Apple Cider

500ml Apple Cider
1/4 tsp Cinnamon

Breakfast Zing

350ml Grapefruit Juice

75ml Lemon Juice

75ml Apple Juice

Frozen Daiquiri

1 cup Fresh, Sliced Strawberries

125ml Strawberry Daiquiri Frozen Ice Mix

190ml chilled Water

60ml chilled Orange Juice

125ml Light Rum

Important: Mix all ingredients in a blender, chill, then place in Drink container.

NOTE: Fresh fruit drinks should be blended and chilled first to achieve optimum results.

When preparing alcoholic drinks, better results are achieved when you add the alcohol 2 minutes before dispensing

8 Schematic Wiring Diagram

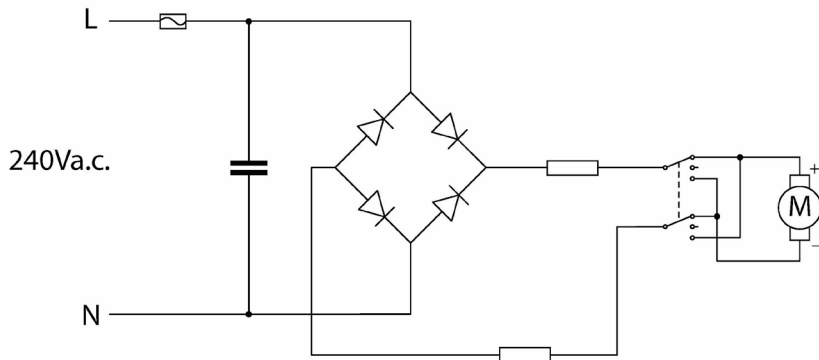

9 Guarantee

What's Covered

H.E. Group Pty Ltd guarantees this Party Drink Maker for a full replacement or refund for a period of twelve months from the date of purchase. This guarantee is valid with the presentation of the original proof of purchase receipt from the store from which you purchased the product in order to establish the purchase price and provide the correct value of the product paid for by you. This guarantee covers materials and workmanship defects only.

What Is Not Covered

This product is for household use only and if used in any way other than as detailed in the instruction manual will void this guarantee. This guarantee does not apply to defects arising from abuse, alteration, or unreasonable use of the product, nor does it cover general deterioration due to usage.

This guarantee does not apply to the accessories due to general deterioration.

What H.E. Group Will Do

H.E. Group Pty Ltd will replace the product or provide a refund to the value of the purchase price, if a defect is discovered in the product during the guaranteed period of twelve months subject to verification of defect or malfunction and the date and proof of purchase and purchase price.

Except as provided for in this guarantee, all express and implied warranties, guarantees and conditions under statute or general law as to the merchantability, description, quality, suitability or fitness of the goods for any purpose, or as to design, assembly, installation, materials or workmanship or otherwise are expressly excluded.

Nothing in this guarantee shall however be read or applied so as to exclude, restrict or modify or have the effect of excluding, restricting or modifying any condition, warranty, guarantee, right or remedy implied by law (including the Trade Practices Act 1974) and which by law cannot be excluded, restricted or modified.

Customer Care

All enquiries may be directed to our friendly customer service team on freecall **1800 079 124** or via email info@hegroup.com.au

Read and Save These Instructions