

# AVITA

## 85L Freezer User Manual

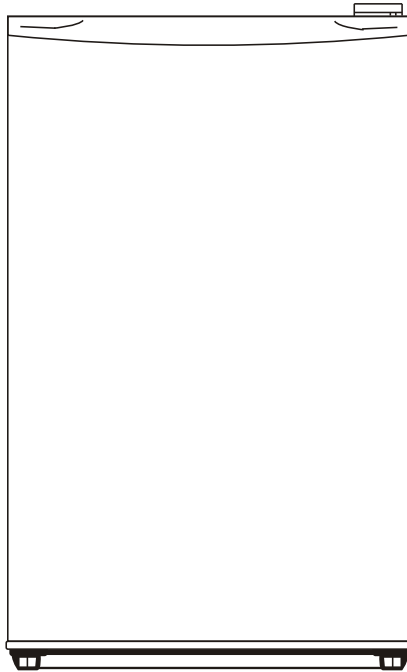

Model No.: DD1-10  
Item No.: 900250  
230-240V~ 50Hz  
Rev 2

1	Important Safeguards.....	3
2	Component Diagram .....	5
3	Before Use .....	6
4	Installation .....	6
4.1	Ventilation Requirements.....	7
4.2	Installation Steps .....	7
5	How to Operate .....	8
5.1	Controlling the Temperature.....	8
6	The Freezer Compartment .....	9
6.1	Freezing Fresh Food.....	9
6.2	Frozen Food Storage .....	10
6.3	Hints and Tips.....	10
7	Cleaning.....	13
8	To Defrost the Freezer .....	13
9	When the Appliance is Not in Use .....	13
10	Door Reversal .....	14
11	Troubleshooting.....	15
12	Technical Specifications.....	16
13	Guarantee .....	17

# 1 Important Safeguards

When using electrical appliances, basic safety precautions should always be followed, including the following:

- Carefully read this instruction manual before using appliance.
- Keep appliance out of reach of young children.
- This appliance is not intended for use by persons (including children) with reduced physical, sensory or mental capabilities, or lack of experience and knowledge, unless they have been given supervision or instruction concerning use of the appliance by a person responsible for their safety.
- Children should be supervised to ensure that they do not play with the appliance.
- Ensure children and babies do not play with plastic bags or any packaging materials.
- This appliance is heavy. Care should be taken when moving it. Do not pull or push using the door. Turn off and unplug before moving.
- Do not attempt to modify this product in any way.
- Whenever possible, the back of the appliance should be close to a wall but leaving the required distance for ventilation as stated in these instructions.
- Do not plug into the power socket before set up is completed. The Freezer should be left to stand for 2 hours after installation and before turning on to allow the refrigerant to settle.
- **VERY IMPORTANT:**  
Ensure that appliance does not get wet (water splashes etc.).  
Do not use appliance with wet hands.  
Do not immerse appliance in water or other liquids or use near sinks, baths or showers.
- Always operate the appliance from a power source of the same voltage, frequency and rating as indicated on the product identification plate.
- Position the power supply lead properly so that it will not be walked on, pinched by items placed on or against it or have the appliance resting on it.
- Use appliance only for its intended use. Appliance is intended for household use only and not for commercial or industrial use.
- Do not use appliance if it has been dropped or any part of appliance (including cord or plug) has been damaged. Take appliance to your nearest authorised service centre or qualified dealer for inspection or repair.
- Use only accessories recommended or supplied by an authorised service centre or qualified dealer. The use of accessories not intended for use with this appliance may cause injuries to the user or damage to the appliance.
- Do not install the unit on other appliances, on uneven surfaces or where it could be subject to: heat sources (e.g. radiators or stoves), direct sunlight, excessive dust or mechanical vibrations.
- Appliance should not be used outdoors, placed near a hot gas or electrical burner or placed in a heated oven.

- Do not install near any heat sources such as radiators, heat registers, stoves, or other apparatus that produce heat.
- Do not operate appliance underneath or near flammable or combustible materials (e.g. curtains).
- Unplug this appliance before cleaning or storing or when unused for long periods of time.
- Any type of servicing, apart from ordinary cleaning, must be carried out by an authorised service centre or qualified dealer. There are no user serviceable parts in this appliance.
- If this appliance is used by a third party, please supply the instruction manual with it.
- Do not misuse the cord. Never carry the appliance by the cord or pull to disconnect it from the outlet. Instead, grasp the plug and pull to disconnect.
- To fix stably, the appliance must be placed on a flat and solid surface. It should not be laid on any soft material.
- When positioned or if moving the appliance ensure that it is not set horizontally or declined more than 45° or turned upside down.
- Do not use the unit in very hot or humid places, such as bathrooms or under direct sunlight.
- Close the Freezer door immediately after putting in items so the inside temperature will not rise dramatically.
- It is not recommended to use this appliance with an extension cord or power board.
- Do not place any other appliance on top of the Freezer.
- This appliance is designed for domestic use only, specifically for the storage of edible foodstuffs only.
- Frozen food should not be refrozen once it has thawed out.
- Do not place carbonated or fizzy drinks in the freezer.
- Ice lollies can cause 'frost/freezer burns' if consumed straight from the freezer.
- Do not remove items from the freezer if your hands are damp/wet, as this could cause skin abrasions or frost/freezer burns.
- An empty Freezer can be a dangerous attraction to children. If disposing of the Freezer, remove gaskets, latches, lids or the entire door from your unused appliance, or take other action to ensure the Freezer is harmless.
- No liability can be accepted for any damage caused by non-compliance with these instructions or any other improper use or mishandling of appliance.
- This product has not been designed for any uses other than those specified in this booklet

## **Read and Save These Instructions**

## 2 Component Diagram

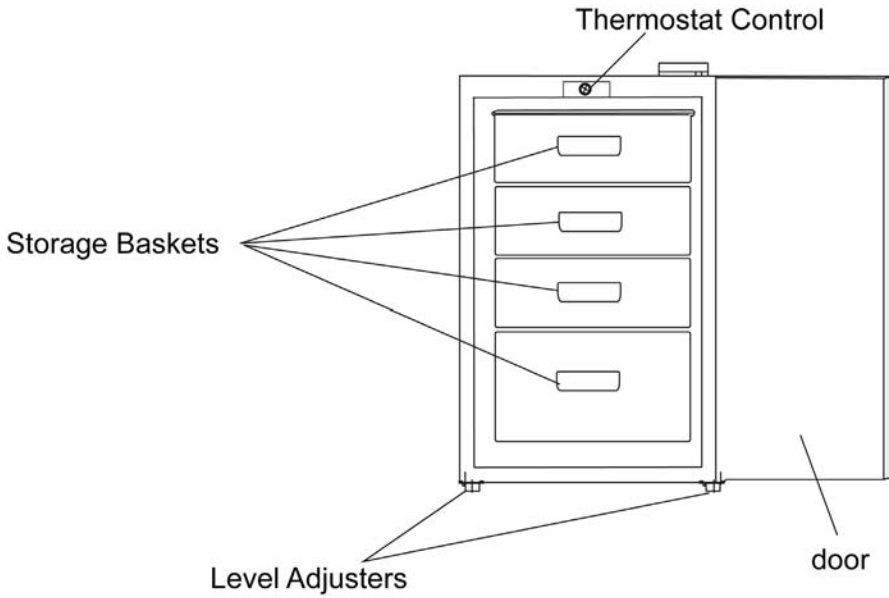

### Thermostat Control

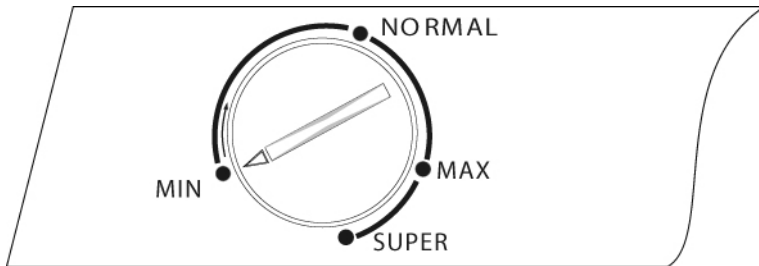

### 3 Before Use

Remove all securing tapes.

Wash the inside of the appliance with lukewarm water with a little Bicarbonate of Soda added (10ml of Bicarbonate of Soda to 1 litre of water).

**Note:** Do not use detergents, abrasive powders, highly perfumed cleaning products, wax polishes or products containing alcohol, etc. as these may damage the unit.

Dry the appliance thoroughly.

### 4 Installation

Do not allow children to tamper with the controls or play with the product.

This appliance is designed for domestic use only, specifically for the storage of edible foodstuffs.

This appliance is designed to operate in ambient temperatures (surrounding air temperature) between 16°C and 32°C.

Outside this temperature range, the freezer may not operate correctly.

Place the Freezer on a strong and level floor. Unstable installation can produce noise and vibration

Place your Freezer where there is no heat source nearby. High atmosphere temperatures will lower cooling efficiency.

Place the Freezer in an area where the humidity level is low. Splashing water on the Freezer or installing the unit in a humid area may cause a short circuit and rust the cabinet.

Avoid places that are exposed to coal fires, gas heating or smoke as discolouring may occur on the Freezer.

Placing the Freezer on carpet may cause a temperature rise, and result in discolouration of the carpet. In such a case, place a hard wooden board or rubber mat between the carpet and the unit.

## 4.1 Ventilation Requirements

For good ventilation keep enough space between the side walls and your Freezer. Its back needs to be at least 50mm away from the wall, its sides at least 25mm separately and the height from over its top is not less than 50mm.

Gently push the Freezer into place, ensuring that the back of the freezer maintains a gap of 50mm from the wall.

When in position a 50mm clear space above the appliance should ideally be maintained.

If insufficient space is available above the freezer, a clearance of 25mm should be maintained on both sides.

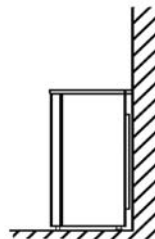

Ensure that the appliance does not stand on the electrical supply cable.

Whenever possible, the back of the appliance should be close to a wall, leaving the required distance for ventilation.

## 4.2 Installation Steps

Select a safe place to install your Freezer.

The appliance should be level during use.

To eliminate rocking:

Ensure the appliance is upright and both adjusters are in firm contact with the floor so that the cabinet is level.

Adjust the level by screwing out the appropriate level adjuster at the front ( use your fingers or a suitable spanner).

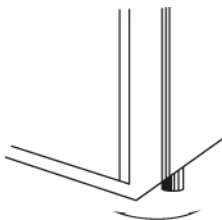

This appliance is heavy. Care should be taken when moving it.

Install the parts in their correct position.

Check that the door is completely closed.

Allow the appliance to stand for 2 hours after installation before plugging in.

After 2 hours, plug in the Freezer and switch on at the mains supply.

Turn the thermostat control to the required setting. A midway setting is usually suitable for normal operation (see Controlling the Temperature).

Leave the appliance for approximately 4 hours for the correct temperature to be reached before placing food inside.

## 5 How to Operate

### 5.1 Controlling the Temperature

The thermostat control, situated in the control panel, regulates the temperature of the freezer compartment.

- Position "Min" – Cold
- Position "Normal" - Colder. This setting is generally most suitable for everyday use.
- Position "Max" - Coldest
- Position "Super" -To fast freeze a quantity of unfrozen food, the compressor works continuously in this mode.

See "Freezing Fresh Food" for further details.

The temperature inside the Freezer will be affected by:

- Ambient room temperature
- How often the door is opened
- How much food is stored
- Position of the appliance

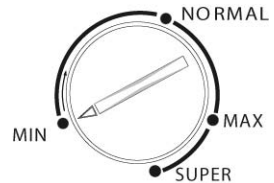

In determining the correct temperature control setting for your situation, all these factors have to be considered, and some experimentation may be necessary

Do not allow children to tamper with the controls or play with the product.

The  symbol means that your freezer will store frozen food at  $-18^{\circ}\text{C}$  or colder, allowing for long term frozen food storage and freezing of fresh food.

The freezer temperature is controlled automatically by the thermostat situated in the control panel.

Due to the different installations, methods of usage and weather conditions, adjustments to the temperature settings may be required.

These are best assessed against a temperature reading on a thermometer buried in the frozen food.

The reading must be taken quickly as the thermometer temperature will rise rapidly after removal.

## **6 The Freezer Compartment**

### **6.1 Freezing Fresh Food**

A maximum of 4 kilograms of food can be frozen in 24 hours, using the "Super" mode on the Thermostat Control.

During the freezing process, the temperature of fresh food must be reduced quickly so that ice crystals are kept as small as possible.

If the freezing process takes place slowly, large ice crystals will form and the food quality will be affected.

Food packets to be frozen should be placed in contact with the basket's surface, and should be spaced apart to allow circulation of cold air.

The food to be frozen should not touch the existing frozen contents.

If necessary, removing one of the higher baskets will allow storage of larger items.

For safety reasons, the freezer baskets are fitted with stops but are readily removed by pulling them forward to the stop, then lifting the front and pulling all the way out.

Re-fit by reversing this procedure.

No harm will result if you forget to turn off the fast freeze switch after 24 hours, but for economy, try to remember to turn it off when the freezing process is complete.

### **Important**

***Frozen food should not be refrozen once it has thawed out.***

***Do not remove items from the freezer if your hands are damp/wet, as this could cause skin abrasions or frost/freezer burns.***

## **6.2 Frozen Food Storage**

The appliance has the following net storage volume: 85 litres.

This is a standard measurement and the actual capacity depends upon the density and sizes of the food.

The above figures are based on an average density of 0.32kg per litre.

Pre packed commercially frozen food should be stored in accordance with the manufacturer's instructions for a 4 star frozen food compartment and should be put in the freezer as soon as possible after purchase.

Your freezer provides for long term storage which generally means up to 3 months but the length of the time can vary and it is important to follow the recommended times shown on packets of commercially frozen food.

Do not place sealed containers or carbonated liquids such as fizzy drinks into the freezer as it creates pressure on the container which may cause it to explode, resulting in damage to the freezer.

Ice cubes and ice lollies should not be consumed immediately after removal from the freezer as it may result in low temperature skin abrasions.

Manufacturers storage time limits should be adhered to

## **6.3 Hints and Tips**

Any opened packets of frozen food should be rewrapped in airtight materials to prevent surface evaporation, which causes drying or 'freezer burn'.

Frozen food which is allowed to thaw accidentally should either be used immediately or thrown away.

Alternatively, if the food is uncooked and has not been completely defrosted, it can be cooked and then refrozen.

Aim to check use by dates on packets and rotate food regularly.

## **Normal Operating Sounds**

You may hear faint gurgling or bubbling sounds when the refrigerant is pumped through the coils or tubing to the cooling plate/evaporator or the fixed freezer baskets at the rear.

When the compressor is on, the refrigerant is being pumped around and you will hear a whirring sound or pulsating noise from the compressor.

A thermostat controls the compressor, and you will hear a faint 'click' when the thermostat cuts in and out.

## **Food Storage**

To obtain the best results from your appliance, neither hot foods nor liquids which may evaporate, should be placed in the freezer compartment.

Avoid buying frozen food if you cannot store it straight away. The use of an insulated container is advisable. When you arrive home place the frozen food in the freezer immediately.

Keep the time between buying chilled food and placing it in your freezer as short as possible.

Do not pack food together too much. Try to allow air to circulate around each item.

Do not store food uncovered.

Ensure that food placed in the freezer is dated and labelled and used in date order to ensure that food is consumed at its best.

Remove suspect food from your freezer.

Clean any spills immediately - refer to Cleaning Section.

## **Energy Saving Advice**

Do not install the appliance close to sources of heat, such as cookers, dishwashers or radiators.

Use the appliance in a cool, well-ventilated room and make sure that the ventilation openings on the casing are not obstructed.

Avoid unnecessary frosting in the cabinet by packing all foodstuffs into airtight packages before placing them in the freezer

Always leave warm food to cool down to room temperature before placing in the freezer.

Food which is to be frozen (when cool) should be placed in the fridge before being transferred to the freezer.

Thaw frozen food in the fridge. This will ensure safer defrosting of foods and reduce the work of the refrigeration unit.

Try to avoid keeping the door open for long periods, or opening the door too frequently as warm air will enter the cabinet, and cause the compressor to switch on unnecessarily often.

Ensure there are no obstructions preventing the door from closing properly.

It is advisable to periodically clean the refrigeration system at the back of the freezer with a duster or vacuum cleaner.

### **In the Event of a Power Failure**

If there is a power failure during the storage of frozen foods, keep the door closed.

If the temperature within your freezer should rise, do not re-freeze the food without checking its condition.

The following guidelines should assist you:

- Ice Cream: Once thawed should be discarded.
- Fruit and Vegetables: If soft should be cooked and used up.
- Bread and Cakes: Can be re-frozen without danger.
- Shellfish: Should be refrigerated and used up quickly.
- Cooked Dishes: (e.g. Casseroles): Should be refrigerated and used up.
- Large Pieces of Meat: Can be re-frozen, provided that there are ice crystals remaining within them.
- Small Joints: Should be cooked and then re-frozen as cooked dishes.
- Chicken: Should be cooked and re-frozen as a fresh dish

## 7 Cleaning

Before any maintenance or cleaning work is carried out, DISCONNECT the appliance from the ELECTRICITY supply.

### Internal Cleaning

Wash the inside of the appliance with lukewarm water with a little Bicarbonate of Soda added (10ml of Bicarbonate of Soda to 1 litre of water).

### External Cleaning

Wash the outer cabinet with warm soapy water.

**Note:** Do not use detergents, abrasive powders, highly perfumed cleaning products, wax polishes or products containing alcohol, etc. as these may damage the unit.

Dry the appliance thoroughly.

Once or twice a year, the dust on the compressor at the rear of the freezer should be removed with a brush or vacuum cleaner.

Dust accumulation may affect the performance of the freezer, thus increasing electricity consumption.

## 8 To Defrost the Freezer

1. Wrap any food in layers of newspaper or blankets, if you do not have access to another freezer.
2. Switch the appliance off at the wall socket and remove the plug.
3. Open the freezer door.
4. Place a suitable container to collect the defrost water.
5. After defrosting, clean and dry the interior.
6. Switch the appliance on and replace any frozen food.

Defrosting can be speeded up by putting bowls of hot (not boiling) water in the freezer and loosening the frost with a suitable (i.e. not sharp) plastic scraper.

If the temperature of frozen food is allowed to rise during defrosting, its storage life may be shortened.

## 9 When the Appliance is Not in Use

When the appliance is not going to be used for a long period, disconnect from the electricity supply, empty all of the food and clean the appliance, leaving the door ajar to prevent a build-up of stale air.

## 10 Door Reversal

This refrigerator has been built with the door hinges on the right. If you wish to change the opening direction, follow the instructions below:

1. Remove the upper hinge cover ( 6 ) first.
2. Remove the two screws ( 1 ) that hold the upper hinge ( 5 ) (right side) to the frame then take away the upper hinge ( 5 ).
3. Lift the door and place it on a padded surface to prevent scratching it.
4. Remove the two screws ( 8 ) that hold the lower hinge ( 2 ) and then remove the lower hinge ( 2 ).
5. Remove the left front leg ( 4 ) and transfer it to the right side.
6. Move the hole cover plate ( 7 ) to the right side.
7. Before placing this lower hinge ( 2 ), remove the bolt-pin ( 9 ) and reverse the direction of the lower hinge ( 2 ). Then install the lower hinge ( 2 ) onto the left side of the lower frame with two screws ( 8 ).
8. Insert the bolt-pin ( 9 ) into the lower hinge ( 2 ).
9. Set the door in its place making sure it sits on the door seat at the lower hinge ( 2 ).
10. While holding the door in the closed position, attach the upper hinge ( 5 ) left side of the top frame with two screws ( 1 ), do not tighten the two screws ( 1 ) until the top of the door is levelled to the counter top.
11. Install the upper hinge cover ( 6 ) on the upper hinge.

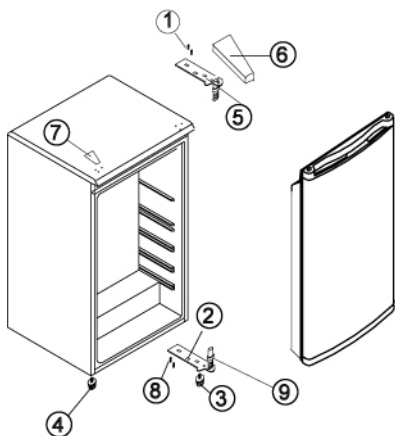

**Before Reversal**

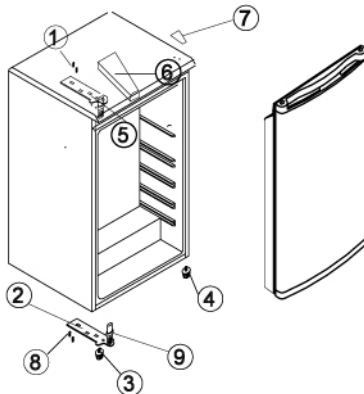

**After Reversal**

# 11 Troubleshooting

**BEFORE contacting a service agent, check the following points:**

Symptom	Solution
No power to the appliance	Check that the fuse has not blown
	Check that there is power at the socket.
The temperature in the freezer section is too high	Check that the ambient temperature is within the freezer's operating limits of 16°C to 32°C. Relocate the appliance if necessary.
	Check that the thermostat is turned to the correct setting, relative to ambient conditions.
The freezer door will not open	If the door has just been opened, you may need to wait a minute or two for the pressure. to equalise
The compressor runs continuously	Make sure that the thermostat is not set to "Super" Refer to "Thermostat Control" section for details
	Check that the door is closed properly and that the door seals are intact and clean
	Large quantities of food have recently been placed in the freezer and /or the door is frequently opened
	Check that sufficient ventilation is available. Refer to "Ventilation Requirements" section for details
Excessive frost and ice has built up	Ensure the door is not left open
	Check that the door is closed properly and that the door seals are intact and clean.
	Check that the door gasket (seal) is intact and clean
	Defrost the freezer Refer to "To Defrost the Freezer" section for details
Noise	Refer to "Normal Operating Sounds" section for details
If condensation forms on the outside of the Freezer:	Condensation may form on the outside when the humidity is high, such as during a wet season.
	This is the same result as the condensation formed when chilled water is poured into a glass. It does not, therefore, indicate a malfunction.
	Wipe dry with a dry cloth

**If after the above checks there is still a fault, contact Customer Support for assistance. In warranty customers should ensure that the above checks have been made before sending for repair, as fees may be levied if the fault is not a mechanical or electrical breakdown.**

## 12 Technical Specifications

Net Weight:	33kg
Supply:	230 - 240V~ 50Hz
Energy Consumption:	0.49kWh/24h
Rated current:	0.8A
Power Rating:	100W
Protection class:	I
Compressor type:	QD65Y
Refrigerant:	R600a(47g)
Tropical Rating:	T
Insulation blowing gas:	Cyclopentane

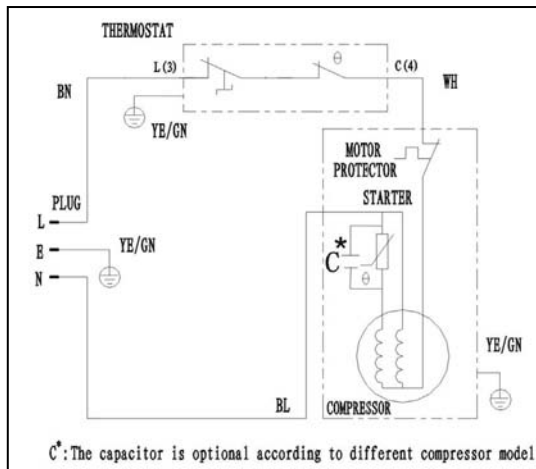

Specification are subject to change without prior notice

## 13 Guarantee

### WHAT'S COVERED

H.E. Group Pty Ltd guarantees this appliance for a full replacement or refund for a period of twelve months from the date of purchase. This guarantee is valid with the presentation of the original proof of purchase receipt from the store from which you purchased the product in order to establish the purchase price and provide the correct value of the product paid for by you. This guarantee covers materials and workmanship defects only.

### WHAT IS NOT COVERED

This product is for household use only and if used in any way other than as detailed in the instruction manual will void this guarantee. This guarantee does not apply to defects arising from abuse, alteration, or unreasonable use of the product, nor does it cover general deterioration due to usage.

This guarantee does not apply to the **accessories** due to general deterioration.

### WHAT H.E. GROUP WILL DO

H.E. Group Pty Ltd will replace the product or provide a refund to the value of the purchase price, if a defect is discovered in the product during the guaranteed period of twelve months subject to verification of defect or malfunction and the date and proof of purchase and purchase price.

Except as provided for in this guarantee, all express and implied warranties, guarantees and conditions under statute or general law as to the merchantability, description, quality, suitability or fitness of the goods for any purpose, or as to design, assembly, installation, materials or workmanship or otherwise are expressly excluded.

Nothing in this guarantee shall however be read or applied so as to exclude, restrict or modify or have the effect of excluding, restricting or modifying any condition, warranty, guarantee, right or remedy implied by law (including the Trade Practices Act 1974) and which by law cannot be excluded, restricted or modified.

### **CUSTOMER CARE**

All enquiries may be directed to our friendly customer service team on **freecall 1800 079 124** or via email [info@hegroup.com.au](mailto:info@hegroup.com.au).

## Read and Save These Instructions